

RendeX®

The RendeX® External Cladding System is a multi-layered exterior wall cladding solution that can be used in Domestic, Commercial and Industrial projects which has been tested for Building Code of Australia (BCA) compliance and certified accordingly:

**CodeMark™ Certificate of Conformity
(CMA-CM40090)**

BRAC Certificate of Accreditation (V13/01)

BAL-29 Certified (SFC 27983000.1)

- 1 Damp-proof course (DPC)
- 2 Sarking
- 3 Battens (when required)
- 4 Starter panels or trims
- 5 RendeX® wall panel
- 6 Screw fasteners and washers
- 7 Expanding urethane foam
- 8 Meshed external beading
- 9 Fibre-glass mesh strip
- 10 Foam and selant for control joints
- 11 Render and wall-coating system

To get all range of RendeX® render, texture and paints, please refer to our website.

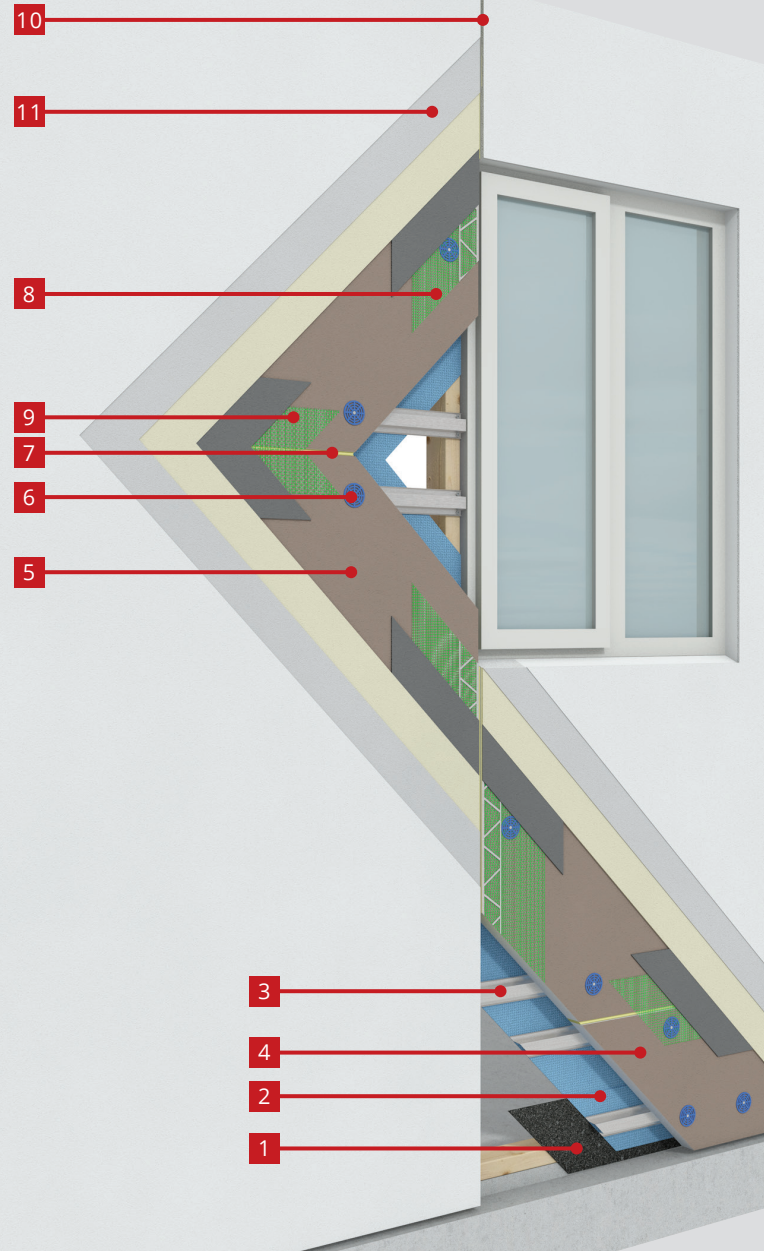

Mouldex®

The Mouldex® Mouldings will help you transform your building project and create a unique and impressive design.

Our mouldings are lightweight, easy to install, made of three components:

The EPS foam core

Fiber-glass reinforcement mesh

Mouldex® FLEXCOAT coating